

		Pag. Page
Indice	Index	
Caratteristiche tecniche	<i>Technical features</i>	B2
Versioni	<i>Versions</i>	B2
Designazione	<i>Classification</i>	B3
Sensi di rotazione	<i>Direction of rotation</i>	B3
Simbologia	<i>Symbols</i>	B3
Lubrificazione	<i>Lubrication</i>	B4
Carichi radiali in entrata	<i>Input radial loads</i>	B6
Carichi radiali in uscita	<i>Output radial loads</i>	B6
Dati tecnici	<i>Technical data</i>	B7
Dimensioni	<i>Dimensions</i>	B20
Accessori	<i>Accessories</i>	B28

Questa sezione annulla e sostituisce ogni precedente edizione o revisione. Qualora questa sezione non Vi sia giunta in distribuzione controllata, l'aggiornamento dei dati ivi contenuto non è assicurato. **In tal caso la versione più aggiornata è disponibile sul nostro sito internet www.transtecno.com**

*This section replaces any previous edition and revision. If you obtained this catalogue other than through controlled distribution channels, the most up to date content is not guaranteed. **In this case the latest version is available on our web site www.transtecno.com***

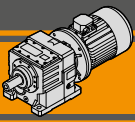

ITH

Motoriduttori ad ingranaggi cilindrici Helical in-line gearmotors

Caratteristiche tecniche

I motoriduttori della serie ITH sono dedicati ad applicazioni industriali che presentano carichi particolarmente gravosi. La costruzione robusta con carcassa in ghisa e l'elevata modularità dei diversi kit di entrata e di uscita li rendono adatti ad ogni tipo di applicazione.

Caratteristiche comuni a tutta la serie sono:

- Costruzione robusta con carcassa in ghisa;
- Elevata modularità;
- Lubrificazione con olio sintetico;
- Accoppiamento al motore tramite giunto elastico.
- Verniciatura a polvere epossidica RAL 7016 di spessore medio 0,10 – 0,15 mm.

Technical features

The ITH gearmotors are intended for heavy duty applications. The robust one pieces casing of the main housing and the modular design of input and output sets increase application flexibility.

The main features of ITH range are:

- Robust cast iron housings;
- High degree of modularity;
- Lubrication with synthetic oil;
- Coupled to motor with flexible coupling.
- Epoxy powder coating RAL 7016 average thickness 0,10 – 0,15 mm.

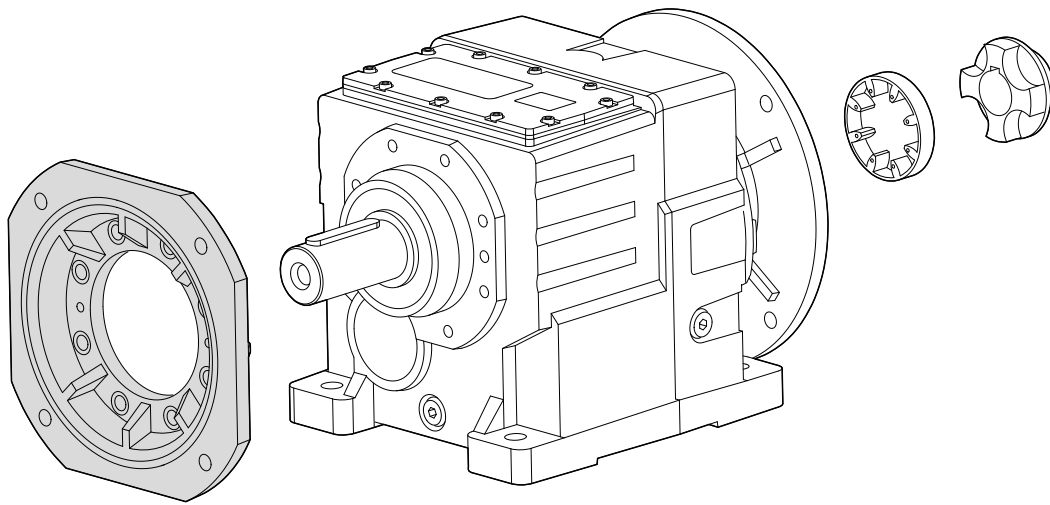

Versioni

Versions

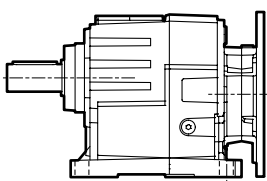

U

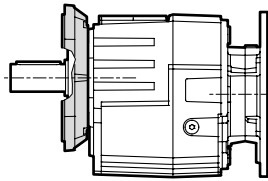

F...

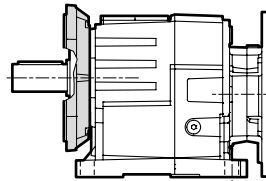

U/F...

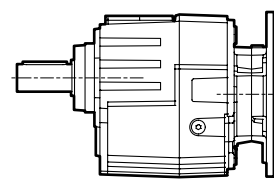

G

RIDUTTORE / GEARBOX

ITH	12	2	H	26.28	D40	132	B5	M1	CW
Tipo Type	Grandezza Size	Stadi Stages	Versione Version	Rapporto Ratio	Albero uscita Output shaft	IEC	Forma costruttiva Version	Pos. di montaggio Mounting position	Dispositivo antiretro Backstop device
	11 12 13 14	2 3	U F... U/F... G	vedi tabelle see tables	vedi tabelle see tables	71.. — 200..	B5 B14	M1 (B3) M2 (V6) M3 (B8) M4 (V5) M5 (B7) M6 (B6)	CW CCW

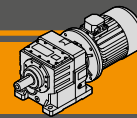

Designazione

Classification

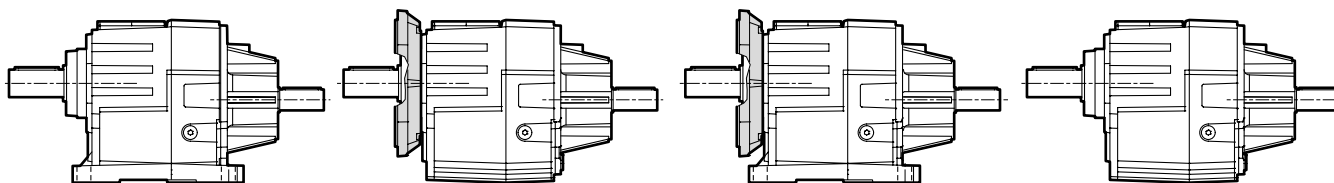

U

F...

U/F...

G

RIDUTTORE / GEARBOX

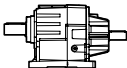
ITHIS	12	2	H	26.28	D40	M1
Tipo Type	Grandezza Size	Stadi Stages	Versione Version	Rapporto Ratio	Albero uscita Output shaft	Pos. di montaggio Mounting position
ITHIS 	11 12 13 14	2 3	U F... U/F... G	vedi tabelle see tables	vedi tabelle see tables	M1 (B3) M2 (V6) M3 (B8) M4 (V5) M5 (B7) M6 (B6)

MOTORE / MOTOR

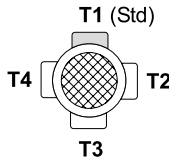
5.5kW	4p	3ph	230/400V	50Hz	T1
Potenza Power	Poli Poles	Fasi Phases	Tensione Voltage	Frequenza Frequency	Pos. morsettiere Terminal box pos.
vedi tabelle see tables	2p 4p 6p 8p	1ph 3ph	230/400V 220/380V ... 230V	50Hz 60Hz	T1 (Std) 

Sensi di rotazione

Direction of rotation

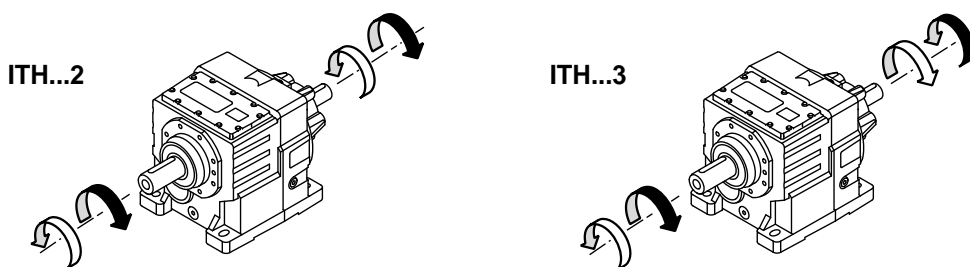

Simbologia

Symbols

n_1	[min^{-1}]	Velocità in ingresso / Input speed
n_2	[min^{-1}]	Velocità in uscita / Output speed
i		Rapporto di riduzione / Ratio
P_1	[kW]	Potenza in entrata / Input power
M_2	[Nm]	Coppia nominale in uscita in funzione di P_1 / Output torque referred to P_1
P_{n1}	[kW]	Potenza nominale in entrata / Nominal input power
M_{n2}	[Nm]	Coppia nominale in uscita in funzione di P_{n1} / Nominal output torque referred to P_{n1}
sf		Fattore di servizio / Service factor
R_1	[N]	Carico radiale ammissibile in entrata / Permitted input radial load
A_1	[N]	Carico assiale ammissibile in entrata / Permitted input axial load
R_2	[N]	Carico radiale ammissibile in uscita / Permitted output radial load
A_2	[N]	Carico assiale ammissibile in uscita / Permitted output axial load

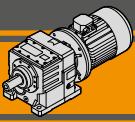

Lubrificazione

Lubrication

I motoriduttori della serie ITH sono forniti completi di lubrificante sintetico viscosità 320. La quantità di lubrificante dipende dalla posizione di montaggio.

ITH series gearmotors come complete with synthetic lubricant 320 viscosity. The lubricant quantity depends on mounting position.

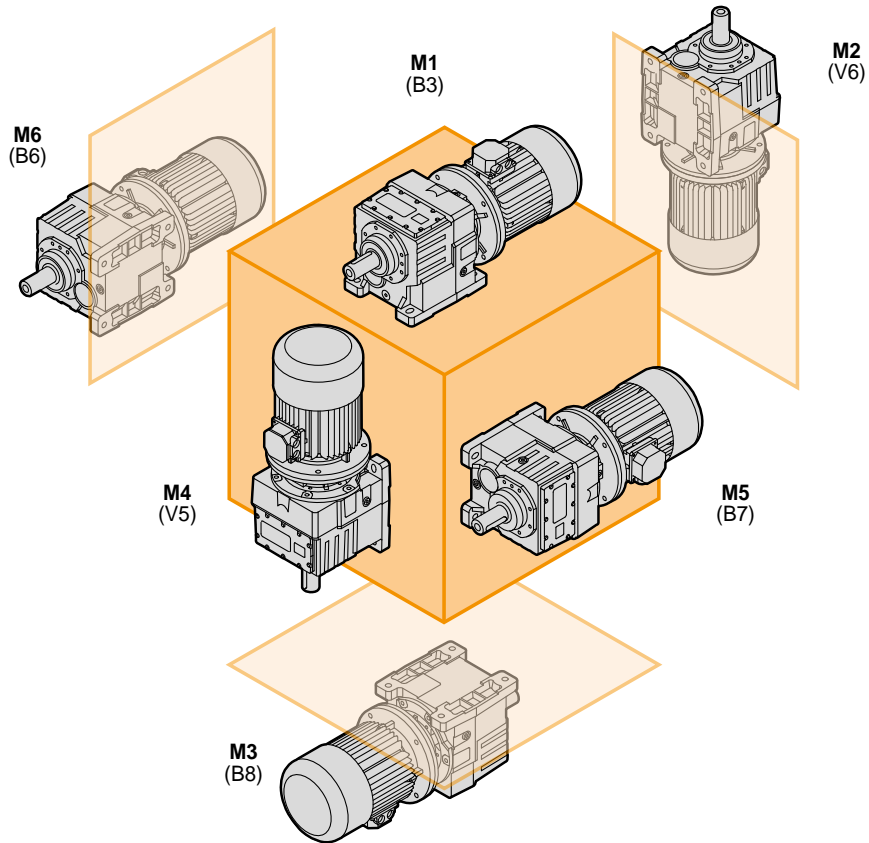

ITH	Quantità di olio (litri) / Oil quantity (litres)					
	M1 (B3)	M2 (V6)	M3 (B8)	M4 (V5)	M5 (B7)	M6 (B6)
112 113	1,1	3,9	3,7	3,4	2,4	2,4
122 123	1,7	5,0	4,3	4,3	3,1	2,9
132 133	4,5	9,5	8,3	8,6	5,9	5,7
142 143	8,1	14,5	11,5	14,4	9,4	9,0

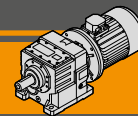

Lubrificazione

Lubrication

ITHIS	Quantità di olio (litri) / Oil quantity (litres)					
	M1 (B3)	M2 (V6)	M3 (B8)	M4 (V5)	M5 (B7)	M6 (B6)
112 113	1,3	4,3	3,9	3,4	2,6	2,6
122 123	1,9	5,4	4,5	4,3	3,3	3,1
132	3,7	10,2	8,7	8,6	6,3	6,1
133	3,5	9,9	8,5		6,1	5,9
142	7,3	15,2	11,9	14,4	9,8	9,4
143	7,1	14,9	11,7		9,6	9,2

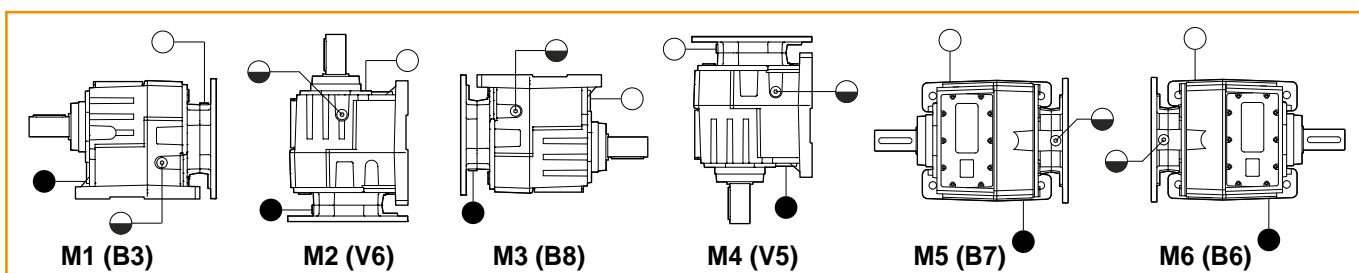

- Sfiato e tappo di riempimento / Breather and filling plug
- ◐ Livello olio / Oil level plug
- Tappo di scarico / Oil drain plug

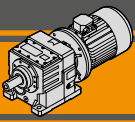

Carichi radiali in entrata

Input Radial loads

ITH 113	n ₁ [min ⁻¹]	Potenza motore/ Motor Power [kW]		
		1.1	1.5	1.85
R ₁ [N]	1400	1250		
	900	1500		500
	500	1750	-	-

ITH 112 ITH 122 -123 ITH 133 - 143	n ₁ [min ⁻¹]	Potenza motore/ Motor Power [kW]			
		2.2	3.0	4.0	5.5
R ₁ [N]	1400	1800			750
	900	2100		1200	-
	500	2500	-	-	-

ITH 132 ITH 142	n ₁ [min ⁻¹]	Potenza motore/ Motor Power [kW]					
		5.5	7.5	9.2	11.0	15.0	18.5
R ₁ [N]	1400	3700				2800	1200
	900	4900			3300	650	-
	500	5250	3900	1300	-	-	-

I carichi radiali uscita massimi applicabili sono riportati nelle tabelle precedenti.
Quando il carico radiale risultante non è applicato sulla mezzeria dell'albero occorre calcolare quello effettivo con la seguente formula:

The radial loads maximum output applicable are indicated in the previous tables.
When the resulting radial load is not applied on the centre line of the shaft it is necessary to calculate the effective load with the following formula:

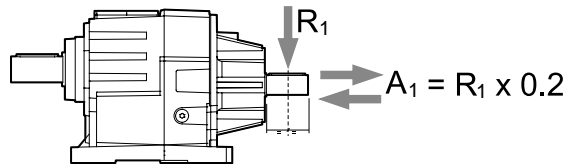
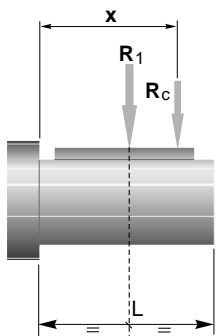

	ITH 112	ITH 113	ITH 122	ITH 123	ITH 132	ITH 133	ITH 142	ITH 143
a	139	134	139	157	139	157	139	
b	110	110	110	118	110	118	110	

$$R_c = \frac{R_1 \cdot a}{(b + x)} \leq R_1$$

a, b = valori riportati nella tabella
a, b = values given in the table

$$R \leq R_c$$

Carichi radiali in uscita

Output Radial loads

I carichi radiali uscita massimi applicabili sono riportati nelle tabelle dati tecnici.
Quando il carico radiale risultante non è applicato sulla mezzeria dell'albero occorre calcolare quello effettivo con la seguente formula:

The radial loads maximum output applicable are indicated in the technical data table.
When the resulting radial load is not applied on the centre line of the shaft it is necessary to calculate the effective load with the following formula:

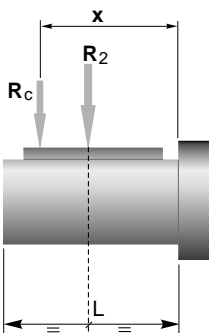

	ITH 112	ITH 113	ITH 122	ITH 123	ITH 132	ITH 133	ITH 142	ITH 143
a	184	208	247	286				
b	149	168	197	226				
R _{2MAX}	8200	12500	18500	22500				

$$R_c = \frac{R_2 \cdot a}{(b + x)} \leq R_{2MAX}$$

a, b = valori riportati nella tabella
a, b = values given in the table

$$R \leq R_c$$

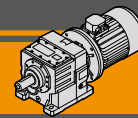

Dati tecnici

n_1 1400 min⁻¹

Technical data

	n_2 [min ⁻¹]	Mn_2 [Nm]	Pn_1 [kW]	i	R_2 [N]
---	-------------------------------	----------------	----------------	-----	--------------

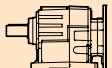
	IEC Motori applicabili IEC Motor adapters
---	--

ITHIS 112

261	350	9.94	5.38	3437
216	350	8.26	6.47	3829
178	400	7.76	7.88	4111
164	400	7.15	8.54	4311
155	420	7.08	9.06	4381
136	420	6.24	10.28	4717
123	480	6.43	11.39	4734
112	480	5.86	12.52	5001
95	500	5.16	14.80	5408
77	530	4.47	18.10	5903
69	530	4.00	20.25	6302
60	600	3.90	23.52	6389
54	600	3.50	26.16	6798
49	650	3.45	28.77	6794
44	680	3.23	32.18	7003
39	680	2.86	36.35	7519
34	680	2.50	41.57	8130
29	600	1.90	48.27	8200
25	600	1.60	57.21	8200

ITH 112

71 B5	80 B5	90 B5/B14	100 B5/B14	112 B5/B14	132 B5/B14
					*
				*	
				*	
				*	
				*	
			*	*	
			*	*	

ITHIS 113

25	700	1.98	55.27	8200
21	700	1.61	67.61	8200
19	700	1.46	74.96	8200
15	700	1.19	91.70	8200
13	700	1.00	108.91	8200
10	700	0.80	136.65	8200
8.5	700	0.67	163.98	8200
8.1	700	0.63	173.44	8200
7.6	700	0.59	185.20	8200
6.9	700	0.54	201.58	8200
6.6	700	0.51	212.17	8200
6.2	700	0.48	226.55	8200
5.7	700	0.44	246.59	8200

ITH 113

71 B5	80 B5	90 B5/B14
		*
		*
		*
		*
		*
		*
	*	*
	*	*

N.B.
Le aree evidenziate indicano l'applicabilità della corrispondente grandezza motore.

N.B.
Highlighted areas indicate motor inputs available on each size of unit.

 * = Il fattore di servizio (sf) deve essere scelto in funzione dell'applicazione: si prega di contattare il nostro Servizio Tecnico.

 * = The service factor (sf) has to be selected depending on application: please contact our Technical Department.

Prima di eseguire la scelta del motoriduttore riferirsi alle prestazioni elencate nelle tabelle dalla pag. B11 alla pag. B19.

Before selecting any gearbox, please read the performance values shown in the tables on page B11 to B19.

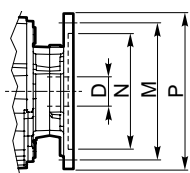

Dimensioni IEC / IEC Dimensions								
	71 B5	80 B5	90 B5	90 B14	100/112 B5	100/112 B14	132 B5	132 B14
N	110	130	130	95	180	110	230	130
M	130	165	165	115	215	130	265	165
P	160	200	200	140	250	160	300	200
D	14	19	24		28		38	

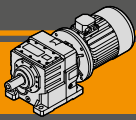

Dati tecnici

n_1 1400 min⁻¹

Technical data

	n_2 [min ⁻¹]	Mn_2 [Nm]	Pn_1 [kW]	i	R_2 [N]
---	-------------------------------	----------------	----------------	-----	--------------

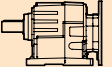
	IEC Motori applicabili IEC Motor adapters			
---	--	--	--	--

ITBIS 122

271	550	16.25	5.17	4751
209	550	12.56	6.69	5522
180	600	11.76	7.79	5878
159	650	11.25	8.82	6149
139	750	11.36	10.08	6278
123	750	10.09	11.35	6727
105	850	9.76	13.30	6946
88	850	8.15	15.92	7713
82	850	7.59	17.11	8045
72	850	6.66	19.50	8683
65	900	6.41	21.43	8887
58	980	6.24	24.00	9005
53	980	5.70	26.28	9494
48	980	5.09	29.40	10136
43	980	4.63	32.31	10710
40	980	4.22	35.47	11309
34	980	3.58	41.78	12500
31	980	3.27	45.73	12500
28	980	2.97	50.40	12500

ITB 122

80 B5	90 B5/B14	100 B5/B14	112 B5/B14	132 B5/B14
				*
				*
			*	
			*	

ITBIS 123

25	980	2.73	56.00	12500
23	980	2.49	61.31	12500
20	980	2.17	70.53	12500
17	980	1.89	81.00	12500
16	980	1.72	88.68	12500
13	980	1.45	105.23	12500
12	980	1.33	115.21	12500
11	980	1.19	128.73	12500
9.7	980	1.06	144.00	12500
8.9	980	0.97	157.66	12500
7.9	980	0.86	178.10	12500
6.9	980	0.75	203.65	12500
6.5	980	0.71	216.00	12500
5.9	980	0.65	236.49	12500
5.5	980	0.60	256.00	12500
5.0	980	0.55	280.29	12500

ITB 123

71 B5	80 B5	90 B5/B14	100 B5/B14	112 B5/B14
				*
				*
				*
			*	*
			*	*
			*	*
			*	*
			*	*
			*	*
			*	*
		*	*	*
		*	*	*
		*	*	*
		*	*	*
		*	*	*

N.B.
Le aree evidenziate indicano l'applicabilità della corrispondente grandezza motore.

N.B.
Highlighted areas indicate motor inputs available on each size of unit.

 * = Il fattore di servizio (sf) deve essere scelto in funzione dell'applicazione: si prega di contattare il nostro Servizio Tecnico.

 * = The service factor (sf) has to be selected depending on application: please contact our Technical Department.

Prima di eseguire la scelta del motoriduttore riferirsi alle prestazioni elencate nelle tabelle dalla pag. B11 alla pag. B19.

Before selecting any gearbox, please read the performance values shown in the tables on page B11 to B19.

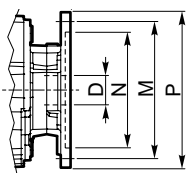

Dimensioni IEC / IEC Dimensions								
	71 B5	80 B5	90 B5	90 B14	100/112 B5	100/112 B14	132 B5	132 B14
N	110	130	130	95	180	110	230	130
M	130	165	165	115	215	130	265	165
P	160	200	200	140	250	160	300	200
D	14	19	24		28		38	

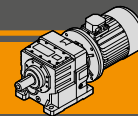

Dati tecnici

n_1 1400 min⁻¹

Technical data

	n_2 [min ⁻¹]	Mn_2 [Nm]	Pn_1 [kW]	i	R_2 [N]
---	-------------------------------	----------------	----------------	---	--------------

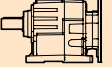
	IEC Motori applicabili IEC Motor adapters					
---	--	--	--	--	--	--

ITHIS 132

278	850	25.8	5.03	10319
230	850	21.3	6.09	11532
203	900	19.9	6.91	12142
186	900	18.3	7.51	12746
167	900	16.4	8.36	13570
155	900	15.2	9.03	14195
136	950	14.1	10.30	14992
127	950	13.2	11.01	15581
113	1200	14.8	12.39	14811
95	1200	12.4	14.80	16426
93	1300	13.1	15.11	15778
75	1500	12.3	18.69	15950
69	1600	12.0	20.31	15734
55	1600	9.5	25.65	18031
51	1700	9.4	27.48	17571
46	1700	8.5	30.46	18500
40	1900	8.4	34.61	17356
37	1900	7.7	37.71	18247
33	1900	6.9	41.80	18500
31	1900	6.4	45.60	18500
28	1900	5.8	49.88	18500

ITH 132

80 B5	90 B5/B14	100 B5/B14	112 B5/B14	132 B5/B14	160 B5	180 B5
*	*	*	*			
						*
						*
						*
						*
						*
						*
						*
						*
						*
						*
						*
						*
					*	*
					*	*

ITHIS 133

23	1900	4.9	60.92	18500
22	1900	4.6	64.74	18500
19.8	1900	4.2	70.88	18500
17.9	1900	3.8	78.38	18500
16.1	1900	3.4	87.14	18500
14.6	1900	3.1	95.67	18500
12.7	1900	2.7	109.93	18500
11.6	1900	2.5	120.36	18500
10.4	1900	2.2	134.66	18500
9.5	1900	2.0	147.98	18500
8.6	1900	1.8	162.45	18500
7.3	1900	1.5	191.39	18500
6.7	1900	1.4	209.48	18500
6.1	1900	1.3	230.85	18500

ITH 133

80 B5	90 B5/B14	100 B5/B14	112 B5/B14	132 B5/B14
				*
				*
				*
				*
			*	*
			*	*
			*	*
			*	*
			*	*
			*	*
		*	*	*
		*	*	*
		*	*	*
		*	*	*
		*	*	*
		*	*	*
		*	*	*

N.B.
Le aree evidenziate indicano l'applicabilità della corrispondente grandezza motore.

 * = Il fattore di servizio (sf) deve essere scelto in funzione dell'applicazione: si prega di contattare il nostro Servizio Tecnico.

Prima di eseguire la scelta del motoriduttore riferirsi alle prestazioni elencate nelle tabelle dalla pag. B11 alla pag. B19.

N.B.
Highlighted areas indicate motor inputs available on each size of unit.

 * = The service factor (sf) has to be selected depending on application: please contact our Technical Department.

Before selecting any gearbox, please read the performance values shown in the tables on page B11 to B19.

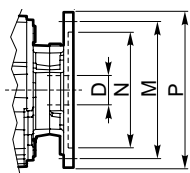

Dimensioni IEC / IEC Dimensions									
	80 B5	90 B5	90 B14	100/112 B5	100/112 B14	132 B5	132 B14	160 B5	180 B5
N	130	130	95	180	110	230	130	250	250
M	165	165	115	215	130	265	165	300	300
P	200	200	140	250	160	300	200	350	350
D	19	24		28		38		42	48

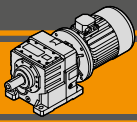
Dati tecnici
 n_1 1400 min⁻¹
Technical data

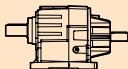
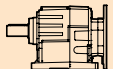
	n_2 [min ⁻¹]	Mn_2 [Nm]	Pn_1 [kW]	i	R_2 [N]		IEC Motori applicabili IEC Motor adapters				
ITHIS 142						ITH 142					
						100 B5/B14	112 B5/B14	132 B5/B14	160 B5	180 B5	200 B5
	228	1800	44.68	6.15	14955						
	190	1800	37.40	7.35	16494						
	158	2000	34.38	8.88	17248	*	*				
	144	2000	31.34	9.75	18150						
	135	2100	30.99	10.35	18181	*	*				
	120	2100	27.54	11.65	19402						
	110	2200	26.30	12.78	19769						*
	99	2300	24.95	14.08	20171						*
	85	2300	21.42	16.40	21936						*
	79	2800	24.11	17.73	19026						*
	69	2800	21.12	20.24	20463						*
	54	3200	18.80	25.99	19654						*
	50	3200	17.39	28.10	20514					*	*
	43	3200	15.11	32.35	22168					*	*
	38	3200	13.18	37.09	22500					*	*
	32	3200	11.22	43.57	22500					*	*
	30	3200	10.32	47.35	22500						
	27	3200	9.44	51.76	22500						

ITHIS 143

23	3500	8.84	61.74	22500
21	3500	8.18	66.73	22500
18	3500	6.87	79.43	22500
16	3500	6.36	85.85	22500
13	3500	4.90	111.40	22500
12	3500	4.53	120.42	22500
11	3500	4.14	131.84	22500
9.5	3500	3.70	147.51	22500
8.6	3500	3.37	162.10	22500
7.9	3500	3.07	177.95	22500
7.2	3500	2.81	193.96	22500
6.7	3500	2.64	209.65	22500
6.1	3500	2.38	229.46	22500
5.5	3500	2.16	252.87	22500

ITH 143

80 B5	90 B5/B14	100 B5/B14	112 B5/B14	132 B5/B14
				*
				*
				*
				*
				*
				*

N.B.

Le aree evidenziate indicano l'applicabilità della corrispondente grandezza motore.



* = Il fattore di servizio (sf) deve essere scelto in funzione dell'applicazione: si prega di contattare il nostro Servizio Tecnico.

Prima di eseguire la scelta del motoriduttore riferirsi alle prestazioni elencate nelle tabelle dalla pag. B11 alla pag. B19.

N.B.

Highlighted areas indicate motor inputs available on each size of unit.



* = The service factor (sf) has to be selected depending on application: please contact our Technical Department.

Before selecting any gearbox, please read the performance values shown in the tables on page B11 to B19.

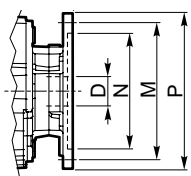



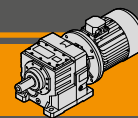

Dimensioni IEC / IEC Dimensions										
	80 B5	90 B5	90 B14	100/112 B5	100/112 B14	132 B5	132 B14	160 B5	180 B5	200 B5
N	130	130	95	180	110	230	130	250	250	300
M	165	165	115	215	130	265	165	300	300	350
P	200	200	140	250	160	300	200	350	350	400
D	19	24		28		38		42	48	55

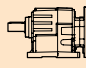

Dati tecnici

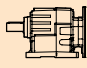

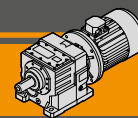

Technical data

P_1 [kW]	n_2 [min ⁻¹]	M_2 [Nm]	sf	i			R_2 [N]	P_1 [kW]	n_2 [min ⁻¹]	M_2 [Nm]	sf	i			R_2 [N]
0.25								0.55							
71A4 (1400 min ⁻¹)	54	43	14	26.16	ITH112	B5	8200	80A4 (1400 min ⁻¹)	260	19	18	5.38	ITH112	B5	4411
	39	60	11	36.35		B5	8200		216	23	15	6.47		B5	4901
34	68	10	41.57	B5		8200	178	28	14	7.88	B5	5479			
29	79	7.6	48.27	B5		8200	164	31	13	8.54	B5	5736			
24	94	6.4	57.21	B5		8200	155	33	13	9.06	B5	5928			
25	89	7.9	55.27	ITH113	B5	8200	136	37	11	10.28	B5	6363	B5	6737	
21	108	6.5	67.61		B5	8200	123	41	12	11.39	B5	6737	B5	7098	
19	120	5.8	74.96		B5	8200	112	45	11	12.52	B5	7098	B5	7783	
15	147	4.8	91.70		B5	8200	95	53	9.4	14.80	B5	7783	B5	8200	
13	175	4.0	108.91		B5	8200	77	65	8.1	18.10	B5	8200	B5	8200	
10	219	3.2	136.65		B5	8200	69	73	7.3	20.25	B5	8200	B5	8200	
8.5	263	2.7	163.98		B5	8200	60	85	7.1	23.52	B5	8200	B5	8200	
8.1	278	2.5	173.44		B5	8200	54	94	6.4	26.16	B5	8200	B5	8200	
7.6	297	2.4	185.20		B5	8200	49	104	6.3	28.77	B5	8200	B5	8200	
6.9	323	2.2	201.58		B5	8200	44	116	5.9	32.18	B5	8200	B5	8200	
6.6	340	2.1	212.17	B5	8200	39	131	5.2	36.35	B5	8200	B5	8200		
6.2	363	1.9	226.55	B5	8200	34	150	4.5	41.57	B5	8200	B5	8200		
5.7	395	1.8	246.59	B5	8200	29	174	3.5	48.27	B5	8200	B5	8200		
7.9	285	3.4	178.10	ITH123	B5	12500	24	206	2.9	57.21	B5	8200	ITH113	B5	8200
6.9	326	3.0	203.65		B5	12500	25	195	3.6	55.27	B5	8200		B5	8200
6.5	346	2.8	216.00		B5	12500	21	238	2.9	67.61	B5	8200		B5	8200
5.9	379	2.6	236.49		B5	12500	19	264	2.6	74.96	B5	8200		B5	8200
5.5	410	2.4	256.00		B5	12500	15	323	2.2	91.70	B5	8200		B5	8200
5.0	449	2.2	280.29		B5	12500	13	384	1.8	108.91	B5	8200		B5	8200
					B5	12500	10	482	1.5	136.65	B5	8200		B5	8200
						8.5	578	1.2	163.98	B5	8200	B5	8200		
						8.1	612	1.1	173.44	B5	8200	B5	8200		
						7.6	653	1.1	185.20	B5	8200	B5	8200		
						6.9	711	1.0	201.58	B5	8200	B5	8200		
						6.6	748	0.9	212.17	B5	8200	B5	8200		
						53	95	10	26.28	ITH122	B5	12500	ITH123	B5	12500
						48	106	9.3	29.40		B5	12500		B5	12500
						43	116	8.4	32.31		B5	12500		B5	12500
						39	128	7.7	35.47		B5	12500		B5	12500
						34	150	6.5	41.78		B5	12500		B5	12500
						31	165	5.9	45.73	B5	12500	B5	12500		
						28	182	5.4	50.40	B5	12500	B5	12500		
						25	197	5.0	56.00	B5	12500	B5	12500		
						23	216	4.5	61.31	B5	12500	B5	12500		
						20	249	3.9	70.53	B5	12500	B5	12500		
						17	286	3.4	81.00	B5	12500	B5	12500		
						16	313	3.1	88.68	B5	12500	B5	12500		
						13	371	2.6	105.23	B5	12500	B5	12500		
						12	406	2.4	115.21	B5	12500	B5	12500		
						11	454	2.2	128.73	B5	12500	B5	12500		
						9.7	508	1.9	144.00	B5	12500	B5	12500		
						8.9	556	1.8	157.66	B5	12500	B5	12500		
						7.9	628	1.6	178.10	B5	12500	B5	12500		
						6.9	718	1.4	203.65	B5	12500	B5	12500		
						6.5	762	1.3	216.00	B5	12500	B5	12500		
						5.9	834	1.2	236.49	B5	12500	B5	12500		
						5.5	903	1.1	256.00	B5	12500	B5	12500		
						5.0	988	1.0	280.29	B5	12500	B5	12500		

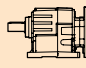

Dati tecnici

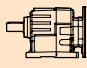

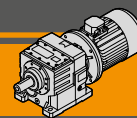

Technical data

P_1 [kW]	n_2 [min ⁻¹]	M_2 [Nm]	sf	i			R_2 [N]	P_1 [kW]	n_2 [min ⁻¹]	M_2 [Nm]	sf	i			R_2 [N]	
1.1								1.1								
90S4 (1400 min ⁻¹)	260	39	9.0	5.38	ITH112	B5/14	4354	90S4 (1400 min ⁻¹)	23	430	4.4	60.92	ITH133	B5/14	18500	
	216	47	7.5	6.47		B5/14	4825		22	457	4.2	64.74		B5/14	18500	
	178	57	7.1	7.88		B5/14	5374		20	500	3.8	70.88		B5/14	18500	
	164	62	6.5	8.54		B5/14	5617		18	553	3.4	78.38		B5/14	18500	
	155	65	6.4	9.06		B5/14	5798		16	615	3.1	87.14		B5/14	18500	
	136	74	5.7	10.28		B5/14	6204		15	675	2.8	95.67		B5/14	18500	
	123	82	5.8	11.39		B5/14	6550		13	775	2.5	109.93		B5/14	18500	
	112	90	5.3	12.52		B5/14	6881		12	849	2.2	120.36		B5/14	18500	
	95	107	4.7	14.80		B5/14	7500		10	950	2.0	134.66		B5/14	18500	
	77	130	4.1	18.10		B5/14	8200		9.5	1044	1.8	147.98		B5/14	18500	
	69	146	3.6	20.25	B5/14	8200	8.6	1146	1.7	162.45	B5/14	18500				
	60	169	3.5	23.52	B5/14	8200	7.3	1350	1.4	191.39	B5/14	18500				
	54	188	3.2	26.16	B5/14	8200	6.7	1478	1.3	209.48	B5/14	18500				
	49	207	3.1	28.77	B5/14	8200	6.1	1628	1.2	230.85	B5/14	18500				
	44	232	2.9	32.18	B5/14	8200	ITH143	23	435	8.0	61.74	B5/14	22500			
	39	262	2.6	36.35	B5/14	8200		21	471	7.4	66.73	B5/14	22500			
	34	299	2.3	41.57	B5/14	8200		18	560	6.2	79.43	B5/14	22500			
	29	348	1.7	48.27	B5/14	8200		16	606	5.8	85.85	B5/14	22500			
	24	412	1.5	57.21	B5/14	8200		13	786	4.5	111.40	B5/14	22500			
	25	390	1.8	55.27	ITH113	B5/14		8200	12	849	4.1	120.42	B5/14	22500		
	21	477	1.5	67.61		B5/14		8200	11	930	3.8	131.84	B5/14	22500		
	19	529	1.3	74.96		B5/14		8200	9.5	1040	3.4	147.51	B5/14	22500		
	15	647	1.1	91.70		B5/14		8200	8.6	1143	3.1	162.10	B5/14	22500		
	13	768	0.9	108.91		B5/14		8200	7.9	1255	2.8	177.95	B5/14	22500		
	159	64	10	8.82	ITH122	B5/14	8152	7.2	1368	2.6	193.96	B5/14	22500			
	139	73	10	10.08		B5/14	8778	6.7	1479	2.4	209.65	B5/14	22500			
	123	82	9.2	11.35		B5/14	9371	6.1	1618	2.2	229.46	B5/14	22500			
	105	96	8.9	13.30		B5/14	10218	5.5	1784	2.0	252.87	B5/14	22500			
	88	115	7.4	15.92		B5/14	11257	ITH123	90L4 (1400 min ⁻¹)	260	53	6.6	5.38	ITH112	B5/14	4313
	82	123	6.9	17.11		B5/14	11698		216	64	5.5	6.47	B5/14		4769	
	72	140	6.1	19.50		B5/14	12500		178	77	5.2	7.88	B5/14		5299	
	65	154	5.8	21.43		B5/14	12500		164	84	4.8	8.54	B5/14		5531	
	58	173	5.7	24.00		B5/14	12500		155	89	4.7	9.06	B5/14		5703	
	53	189	5.2	26.28		B5/14	12500		136	101	4.2	10.28	B5/14		6088	
	48	212	4.6	29.40	B5/14	12500	123		112	4.3	11.39	B5/14	6414			
	43	233	4.2	32.31	B5/14	12500	112		123	3.9	12.52	B5/14	6723			
	39	255	3.8	35.47	B5/14	12500	95		145	3.4	14.80	B5/14	7294			
34	301	3.3	41.78	B5/14	12500	77	178		3.0	18.10	B5/14	8009				
31	329	3.0	45.73	B5/14	12500	69	199	2.7	20.25	B5/14	8200					
28	363	2.7	50.40	B5/14	12500	60	231	2.6	23.52	B5/14	8200					
25	395	2.5	56.00	ITH123	B5/14	12500	54	257	2.3	26.16	B5/14	8200				
23	432	2.3	61.31		B5/14	12500	49	283	2.3	28.77	B5/14	8200				
20	497	2.0	70.53		B5/14	12500	44	316	2.2	32.18	B5/14	8200				
17	571	1.7	81.00		B5/14	12500	39	357	1.9	36.35	B5/14	8200				
16	626	1.6	88.68		B5/14	12500	34	408	1.7	41.57	B5/14	8200				
13	742	1.3	105.23		B5/14	12500	29	474	1.3	48.27	B5/14	8200				
12	813	1.2	115.21		B5/14	12500	24	562	1.1	57.21	B5/14	8200				
11	908	1.1	128.73		B5/14	12500	ITH113	25	532	1.3	55.27	B5/14	8200			
9.7	1016	1.0	144.00		B5/14	12500		21	650	1.1	67.61	B5/14	8200			
8.9	1112	0.9	157.66		B5/14	12500		19	721	1.0	74.96	B5/14	8200			
55	185	8.7	25.65	ITH132	B5/14	18500										
51	198	8.6	27.48		B5/14	18500										
46	219	7.7	30.46		B5/14	18500										
40	249	7.6	34.61		B5/14	18500										
37	272	7.0	37.71		B5/14	18500										
33	301	6.3	41.80		B5/14	18500										
31	328	5.8	45.60		B5/14	18500										
28	359	5.3	49.88		B5/14	18500										

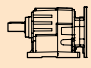

Dati tecnici

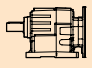
Technical data

P_1 [kW]	n_2 [min ⁻¹]	M_2 [Nm]	sf	i			R_2 [N]	P_1 [kW]	n_2 [min ⁻¹]	M_2 [Nm]	sf	i			R_2 [N]		
11.0								22.0									
160M4 (1400 min ⁻¹)	228	434	4.1	6.15	ITH142	B5	20871	180L4 (1400 min ⁻¹)	278	710	1.2	5.03	ITH132	B5	10941		
	190	529	3.4	7.35		B5	22500		230	878	1.0	6.09		B5	11394		
	158	640	3.1	8.88		B5	22500		ITH142	228	868	2.1		6.15	B5	18992	
	144	702	2.8	9.75		B5	22500			190	1059	1.7		7.35	B5	20034	
	135	745	2.8	10.35		B5	22500			158	1280	1.6		8.88	B5	21065	
	120	839	2.5	11.65		B5	22500			144	1404	1.4		9.75	B5	21474	
	110	920	2.4	12.78		B5	22500			135	1491	1.4		10.35	B5	21693	
	99	1014	2.3	14.08		B5	22500			120	1678	1.3		11.65	B5	22000	
	85	1181	1.9	16.40		B5	22500			110	1840	1.2		12.78	B5	22097	
	79	1277	2.2	17.73		B5	22500			99	2028	1.1		14.08	B5	22028	
	69	1458	1.9	20.24		B5	22500			85	2362	1.0		16.40	B5	21475	
	54	1872	1.7	25.99		B5	22500			79	2555	1.1		17.73	B5	20928	
	50	2024	1.6	28.10		B5	22500		69	2916	1.0	20.24		B5	19494		
	43	2330	1.4	32.35		B5	22500		30.0								
	38	2671	1.2	37.09		B5	22500		200L4 (1400 min ⁻¹)	228	1183	1.5		6.15	ITH142	B5	17626
32	3139	1.0	43.57	B5	22500	190	1444	1.2	7.35	B5	18195						
15.0								158	1745	1.1	8.88	B5	18598				
160L4 (1400 min ⁻¹)	230	598	1.4	6.09	ITH132	B5	11949	144	1915	1.0	9.75	B5	18625				
	203	679	1.3	6.91		B5	12785	135	2033	1.0	10.35	B5	18568				
	186	738	1.2	7.51		B5	13329	120	2288	0.9	11.65	B5	18247				
	167	821	1.1	8.36		B5	13661	200L4 (1400 min⁻¹)									
	155	887	1.0	9.03		B5	14043	228	1183	1.5	6.15	ITH142	B5	17626			
	228	592	3.0	6.15		ITH142	B5	20188	190	1444	1.2		7.35	B5	18195		
		190	722	2.5	7.35		B5	21643	158	1745	1.1		8.88	B5	18598		
		158	873	2.3	8.88		B5	22500	144	1915	1.0		9.75	B5	18625		
		144	957	2.1	9.75		B5	22500	135	2033	1.0		10.35	B5	18568		
		135	1016	2.1	10.35		B5	22500	120	2288	0.9		11.65	B5	18247		
		120	1144	1.8	11.65		B5	22500	18.5								
		110	1255	1.8	12.78		B5	22500	180M4 (1400 min ⁻¹)	278	597		1.4	5.03	ITH132	B5	11445
		99	1383	1.7	14.08		B5	22500		230	738		1.2	6.09		B5	12090
		85	1610	1.4	16.40		B5	22500		203	837		1.1	6.91		B5	12480
		79	1742	1.6	17.73		B5	22500		186	910		1.0	7.51		B5	12692
69		1988	1.4	20.24	B5		22500	ITH142		228	730		2.5	6.15		B5	19590
54		2553	1.3	25.99	B5		22500			190	890		2.0	7.35	B5	20839	
50		2760	1.2	28.10	B5		22500			158	1076		1.9	8.88	B5	22145	
43		3178	1.0	32.35	B5		22410			144	1181		1.7	9.75	B5	22500	
										135	1254	1.7	10.35	B5	22500		
										120	1411	1.5	11.65	B5	22500		
										110	1548	1.4	12.78	B5	22500		
										99	1705	1.3	14.08	B5	22500		
										85	1986	1.2	16.40	B5	22500		
										79	2148	1.3	17.73	B5	22500		
								69		2452	1.1	20.24	B5	22500			
								54	3149	1.0	25.99	B5	20141				

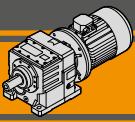

ITH

Motoriduttori ad ingranaggi cilindrici
Helical in-line gearmotors

Dimensioni

Dimensions

ITH 112 - ITH 113

ITH 112 U
ITH 113 U

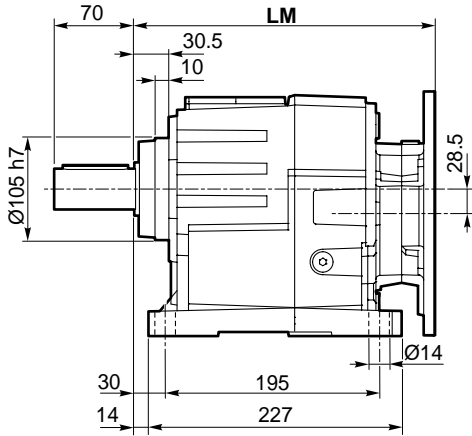

Albero uscita
Output shaft

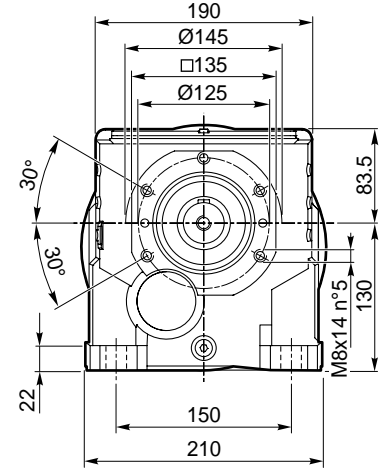
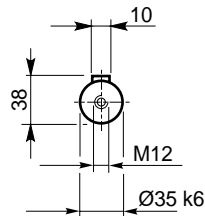

ITH 112 G
ITH 113 G

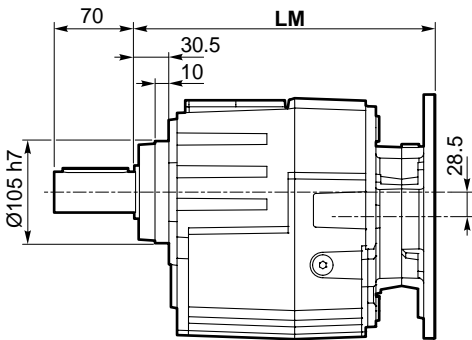

Albero uscita
Output shaft

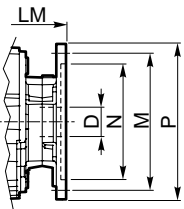
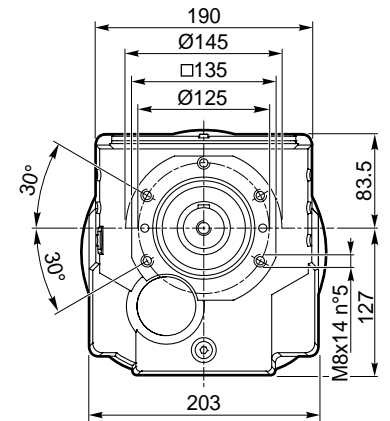
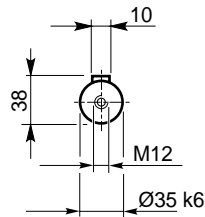

Dimensioni IEC / IEC Dimensions								
	71 B5	80 B5	90 B5	90 B14	100/112 B5	100/112 B14	132 B5	132 B14
LM	289			293,5	293	293,5	314	
N	110	130	130	95	180	110	230	130
M	130	165	165	115	215	130	265	165
P	160	200	200	130	250	160	300	200
D	14	19	24		28		38	

IEC Motori applicabili
IEC Motor adapters

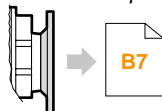

ITHIS 112...
ITHIS 113...

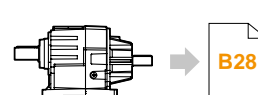

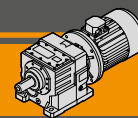

Dimensioni

Dimensions

ITH 112 - ITH 113

ITH 112 U/F...
ITH 113 U/F...

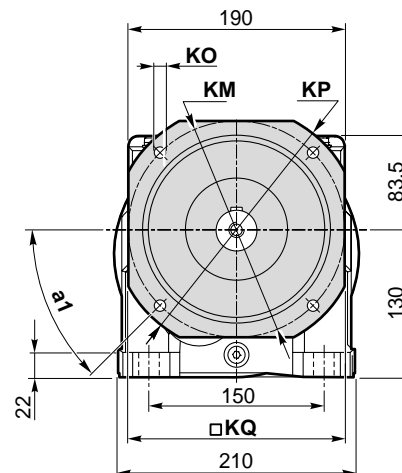
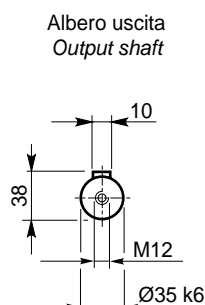
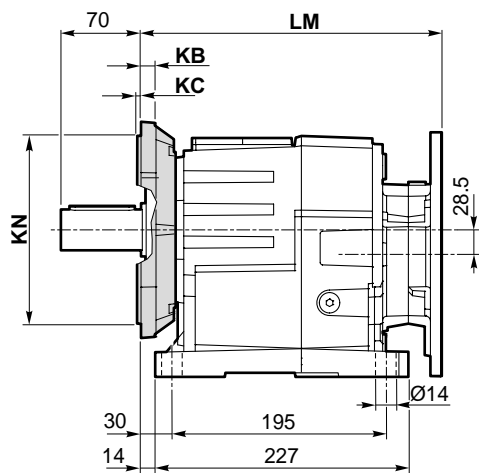

ITH 112 F...
ITH 113 F...

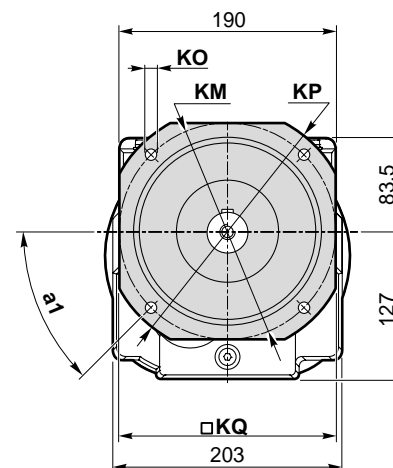
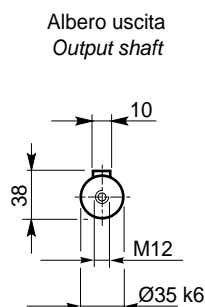
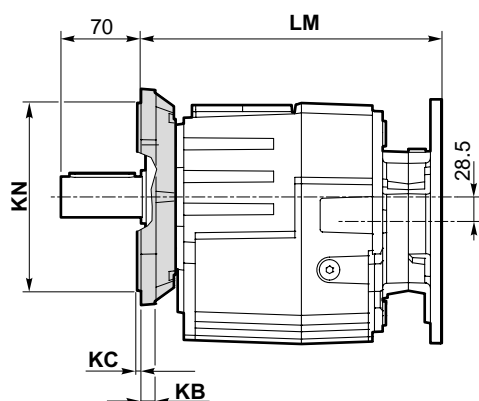

Versione F / F Version											
ITH	a ₁	KB	KC	KM	KN f7	KO	KP	KQ	Flangia / Flange		
									Tipo / Type		Peso / Weight [kg]
112 113	45°	12	4	165	130	11	200	165	F200		2.1
	45°	12	4	215	180	14	250	215	F250		3.2

Peso / Weight [kg]									
ITH	71 B5	80 B5	90 B5	90 B14	100/112 B5	100/112 B14	132 B5	132 B14	
112 U	28	29	29	28	30	28	34	31	
112 G	26	27	27	26	29	26	32	29	
113 U	28	29	29	28	-	-	-	-	
113 G	27	28	28	27	-	-	-	-	

Nota: peso del riduttore complessivo di olio per la posizione M1 (B3)
Note: weight of the gearbox filled with oil for M1 (B3) assembly position

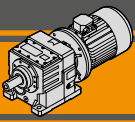

Dimensioni

Dimensions

ITH 122 - ITH 123

ITH 122 U
ITH 123 U

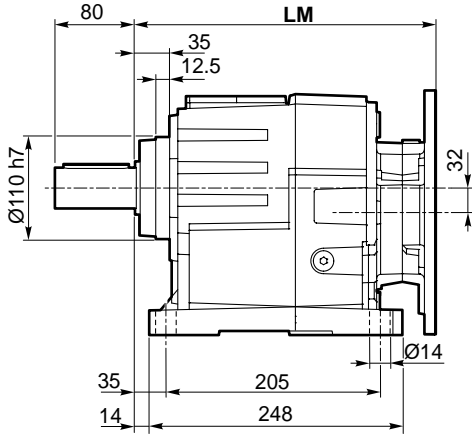

Albero uscita
Output shaft

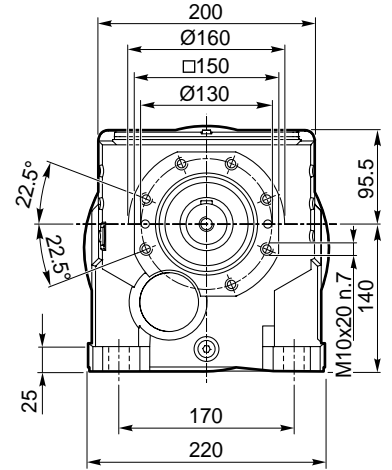
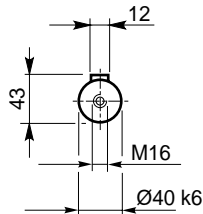

ITH 122 G
ITH 123 G

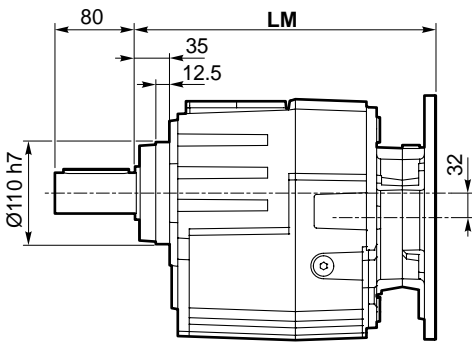

Albero uscita
Output shaft

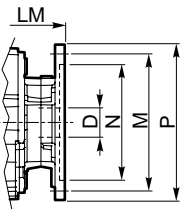
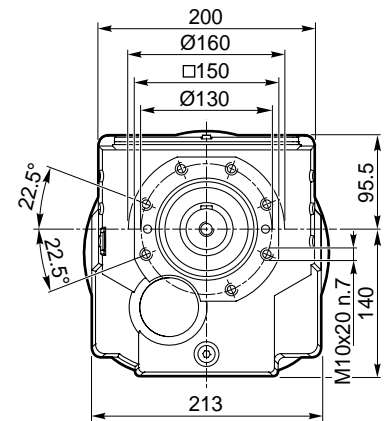
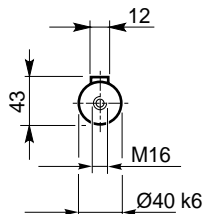

Dimensioni IEC / IEC Dimensions								
	71 B5	80 B5	90 B5	90 B14	100/112 B5	100/112 B14	132 B5	132 B14
LM	309.5			314	313.5	314	334.5	
N	110	130	130	95	180	110	230	130
M	130	165	165	115	215	130	265	165
P	160	200	200	130	250	160	300	200
D	14	19	24		28		38	

IEC Motori applicabili
IEC Motor adapters

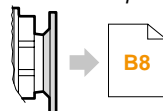

ITHIS 122...
ITHIS 123...

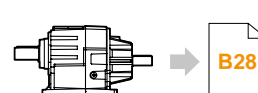

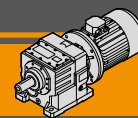

Dimensioni

Dimensions

ITH 122- ITH 123

ITH 122 U/F...
ITH 123 U/F...

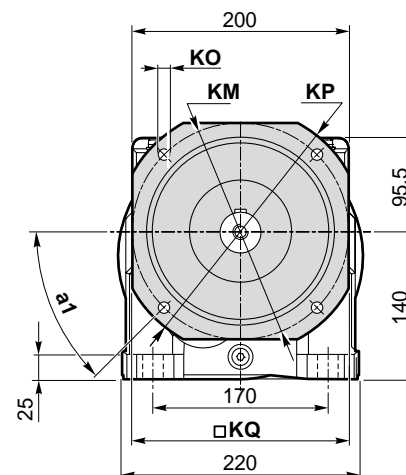
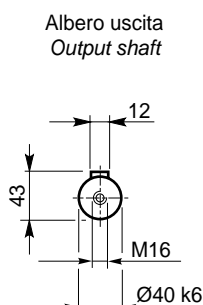
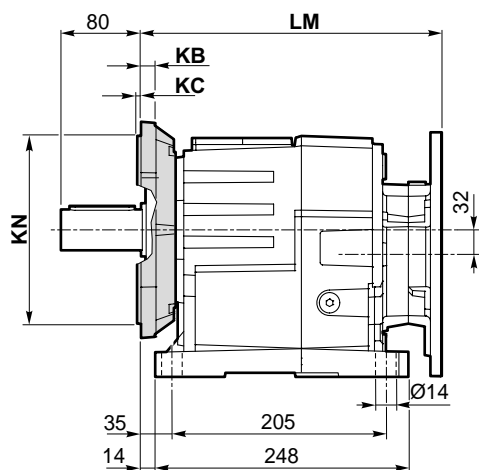

ITH 122 F...
ITH 123 F...

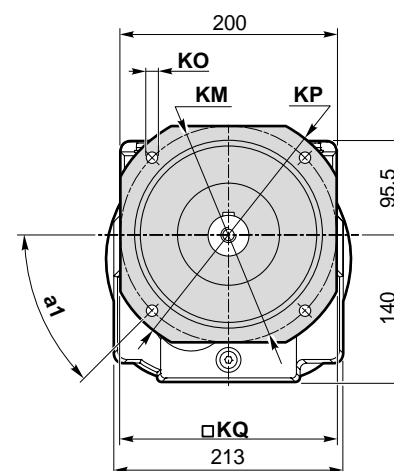
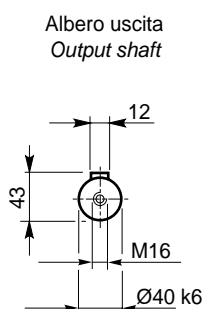
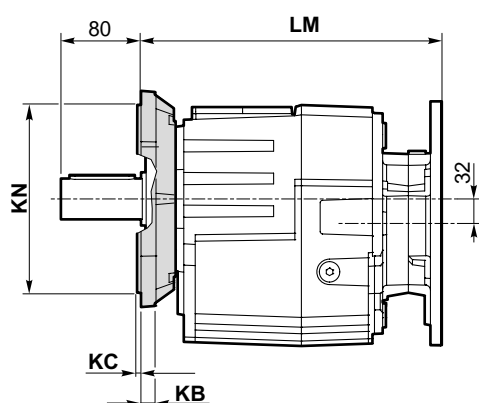

Versione F / F Version

ITH	a ₁	KB	KC	KM	KN f7	KO	KP	KQ	Flangia / Flange	
									Tipo / Type	Peso / Weight [kg]
122 123	45°	13	4	165	130	11	200	172	F200	2.6
	45°	13	4	215	180	14	250	215	F250	3.8
	45°	13	4	265	230	14	300	265	F300	5.6

Peso / Weight [kg]

ITH	71 B5	80 B5	90 B5	90 B14	100/112 B5	100/112 B14	132 B5	132 B14
122 U	-	36	36	35	38	35	41	38
122 G	-	34	34	33	36	33	39	36
123 U	36	37	37	36	39	36	-	-
123 G	34	35	35	34	37	34	-	-

Nota: peso del riduttore complessivo di olio per la posizione M1 (B3)
Note: weight of the gearbox filled with oil for M1 (B3) assembly position



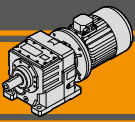

Dimensioni

Dimensions

ITH 132 - ITH 133

**ITH 132 U
ITH 133 U**

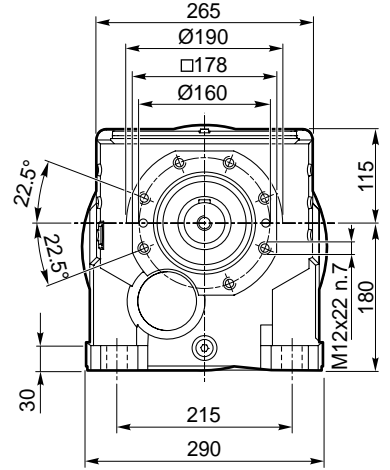
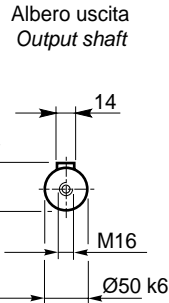
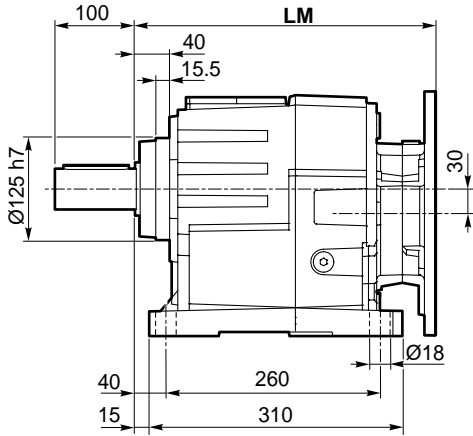

**ITH 132 G
ITH 133 G**

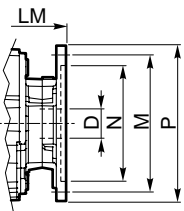
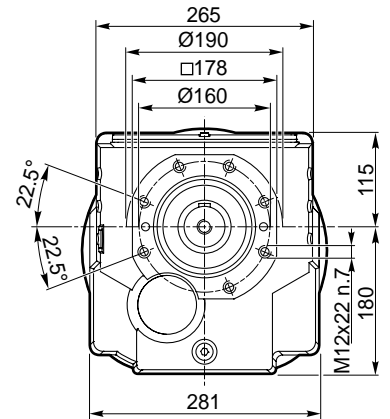
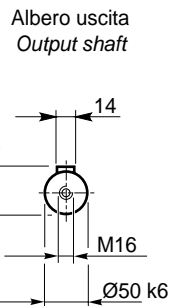
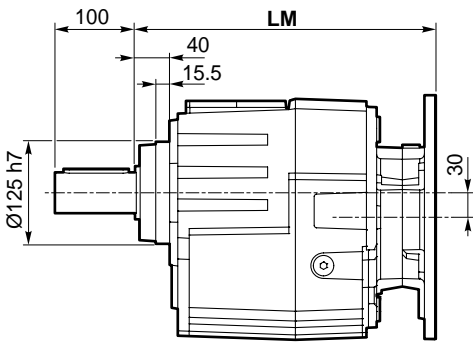

Dimensioni IEC / IEC Dimensions									
	80 B5	90 B5	90 B14	100/112 B5	100/112 B14	132 B5	132 B14	160 B5	180 B5
LM	340.5		345	344.5	345	365.5		415.5	
N	130		95	180	110	230	130	250	
M	165		115	215	130	265	165	300	
P	200		140	250	160	300	200	350	
D	19	24		28		38		42	48

IEC Motori applicabili
IEC Motor adapters

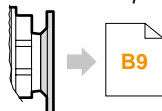

ITHIS 132...
ITHIS 133...

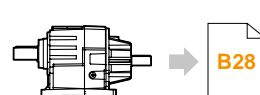

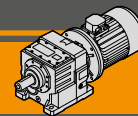

Dimensioni

Dimensions

ITH 132- ITH 133

ITH 132 U/F...
ITH 133 U/F...

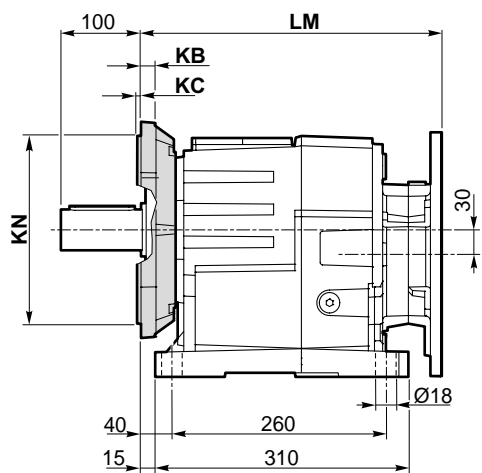

Albero uscita
Output shaft

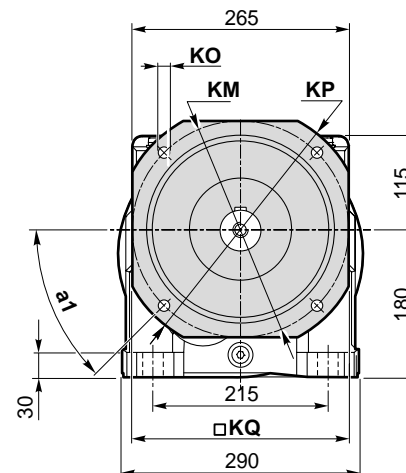
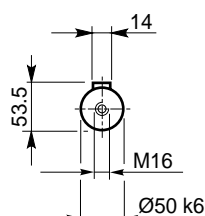

ITH 132 F...
ITH 133 F...

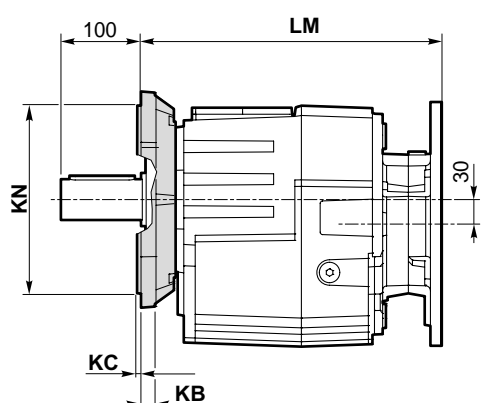

Albero uscita
Output shaft

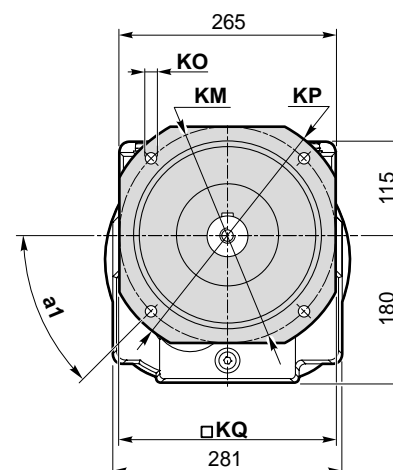
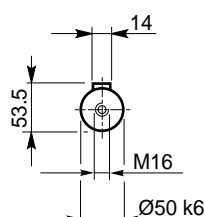

Versione F / F Version

ITH	a ₁	KB	KC	KM	KN f7	KO	KP	KQ	Flangia / Flange	
									Tipo / Type	Peso / Weight [kg]
132 133	45°	16	4	215	180	14	250	215	F250	4.8
	45°	16	4	265	230	14	300	260	F300	7.1
	45°	16	4	300	250	18	350	300	F350	9.1

Peso / Weight [kg]

ITH	80 B5	90 B5	90 B14	100/112 B5	100/112 B14	132 B5	132 B14	160 B5	180 B5
132 U		67	66	68	66	72	69		83
132 G		63	62	64	62	68	65		79
133 U		69	68	70	68	74	71	-	-
133 G		65	64	66	64	70	67	-	-

Nota: peso del riduttore complessivo di olio per la posizione M1 (B3)
Note: weight of the gearbox filled with oil for M1 (B3) assembly position

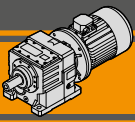

ITH

Motoriduttori ad ingranaggi cilindrici
Helical in-line gearmotors

Dimensioni

Dimensions

ITH 142 - ITH 143

ITH 142 U
ITH 143 U

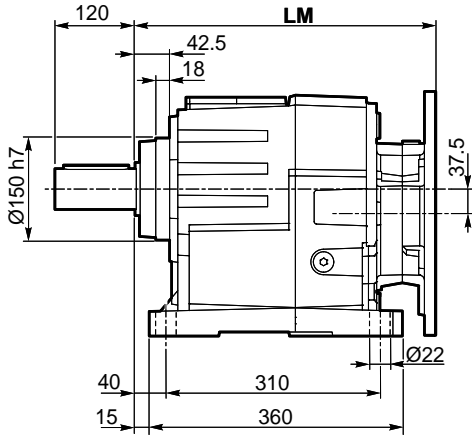

Albero uscita
Output shaft

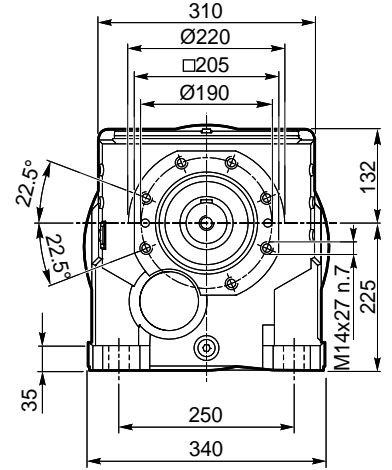
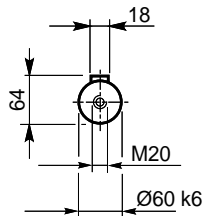

ITH 142 G
ITH 143 G

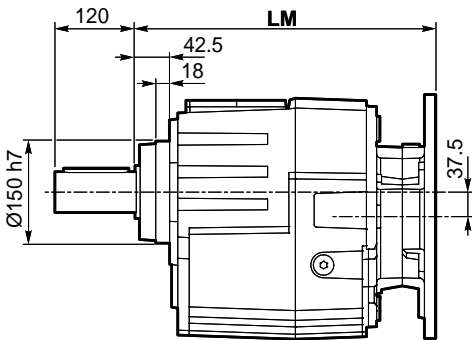

Albero uscita
Output shaft

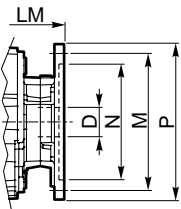
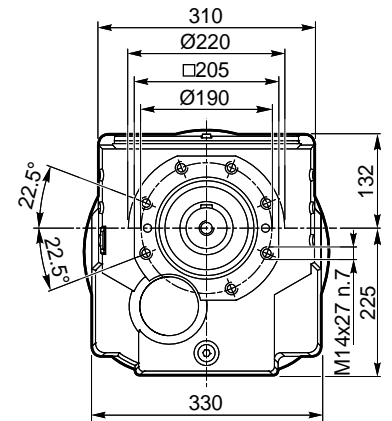
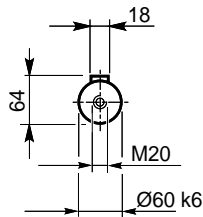

Dimensioni IEC / IEC Dimensions										
	80 B5	90 B5	90 B14	100/112 B5	100/112 B14	132 B5	132 B14	160 B5	180 B5	200 B5
LM	373.5	378	377.5	378	398.5	448.5	460.5			
N	130	95	180	110	230	130	250	300		
M	165	115	215	130	265	165	300	350		
P	200	140	250	160	300	200	350	400		
D	19	24	28	38	42	48	55			

IEC Motori applicabili
IEC Motor adapters

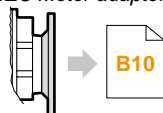

ITHIS 142...
ITHIS 143...

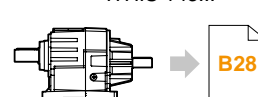

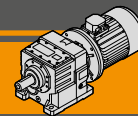

Dimensioni

Dimensions

ITH 142- ITH 143

ITH 142 U/F...
ITH 143 U/F...

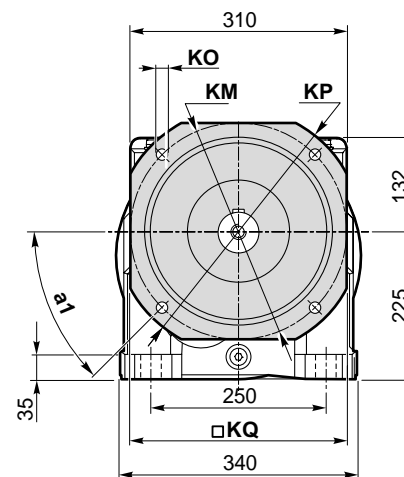
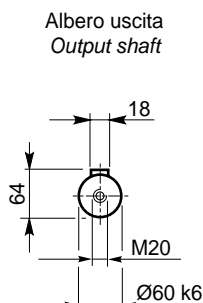
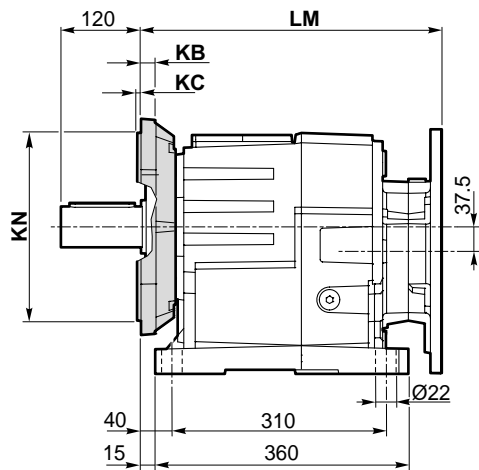

ITH 142 F...
ITH 143 F...

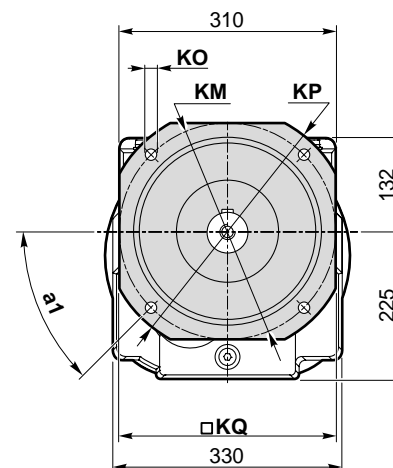
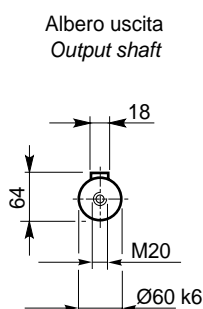
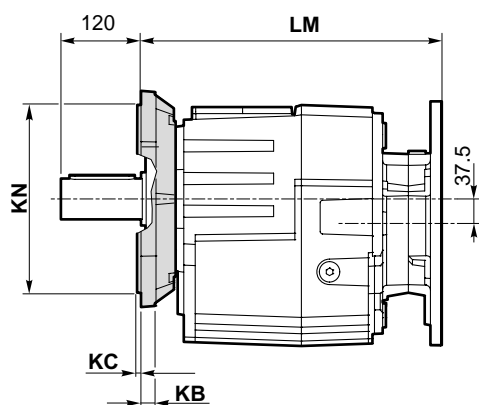

Versione F / F Version

ITH	a ₁	KB	KC	KM	KN f7	KO	KP	KQ	Flangia / Flange Tipo / Type	Peso / Weight [kg]
142 143	45°	18	4	265	230	14	300	265	F300	7.4
	45°	18	5	300	250	18	350	300	F350	10.2
	45°	18	5	400	350	18	450	400	F450	16.9

Peso / Weight [kg]

ITH	80 B5	90 B5	90 B14	100/112 B5	100/112 B14	132 B5	132 B14	160 B5	180 B5	200 B5
142 U	-	-	-	105	102	108	105	119		129
142 G	-	-	-	99	96	102	99	113		123
143 U		106		105	108	105	111	108	-	-
143 G		100		99	102	99	105	102	-	-

Nota: peso del riduttore complessivo di olio per la posizione M1 (B3)
Note: weight of the gearbox filled with oil for M1 (B3) assembly position

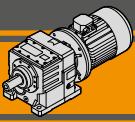

Dimensioni

Dimensions

IThis...

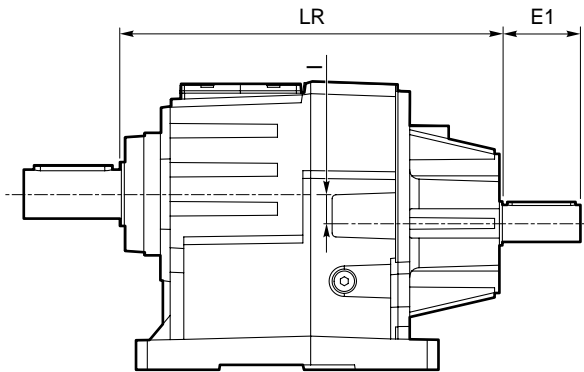

Albero entrata
Input shaft

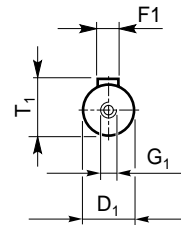

IThis	Peso / Weight [kg]
112 U	29
112 G	28
113 U	30
113 G	28
122 U	37
122 G	35
123 U	38
123 G	36
132 U	73
132 G	69
133 U	69
133 G	65
142 U	110
142 G	104
143 U	107
143 G	101

IThis	Versione Version	LR	D1	E1	I	T1	F1	G1
112	U G U/F... F...	321.5	28	60	28.5	31	8	M10
113		321.5	24	50	28.5	27	8	M8
122		342	28	60	32	31	8	M10
123		342	28	60	32	31	8	M10
132		390.5	38	80	30	41	10	M12
133		373	28	60	30	31	8	M10
142		423.5	38	80	37.5	41	10	M12
143		406	28	60	37.5	31	8	M10

Accessori

Accessories

Dispositivo antiretro / Backstop device

**ITh...CW
ITh...CCW**

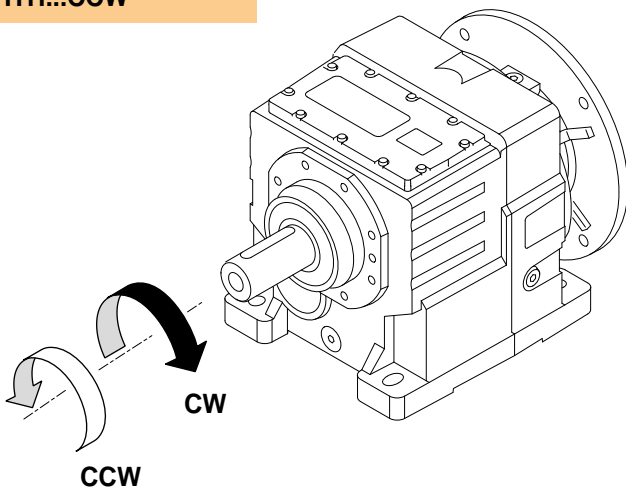

Il dispositivo antiretro permette la rotazione dell'albero in un solo senso senza creare ingombri aggiuntivi. Prima di utilizzarlo è necessario specificare il senso di rotazione dell'albero di uscita come mostrato in figura.

The backstop device allows the output shaft to rotate in just one direction. Before using it, please specify output shaft rotation direction as shown in the figure.