

Motor 88 IP54

S1 SERVIZIO CONTINUO
CONTINUOUS DUTY

1,1-4,4kW

D.C. motors CEI and IEC standards - permanent magnet - 4 poles

Battery supply - rated voltage 12/24/36/48/72/110V

Form factor 1 - self ventilated

Protection IP54 - insulation F / H class

Terminal box



Type	Power	Voltage/Current	Speed	Torque	Power	Voltage/Current	Speed	Torque	Power	Voltage/Current	Speed	Torque
88-38	1,1 kW	12 V - 110 A	1500 rpm	7 Nm	1,1 kW	12 V - 110 A	2200 rpm	4,8 Nm	--	--	--	--
	1,2 kW	24 V - 60 A		7,6 Nm	1,5 kW	24 V - 75 A		6,5 Nm	2,2 kW	24 V - 110 A	3000 rpm	7 Nm
		36 V - 40 A			36 V - 50 A	3200 rpm			6,6 Nm			
		48 V - 30 A			48 V - 37 A	3000 rpm			7 Nm			
88-57	1,1 kW	12 V - 110 A	1500 rpm	7 Nm	--	--	--	--	--	--	--	--
	1,7 kW	24 V - 85 A		10,8 Nm	2,2 kW	24 V - 110 A	1950 rpm	10,7 Nm	2,2 kW	24 V - 110 A	3000 rpm	7 Nm
		36 V - 57 A			36 V - 74 A	2100 rpm	10 Nm	3,3 kW	36 V - 110 A	10,5 Nm		
		48 V - 42 A			48 V - 55 A	1950 rpm	10,7 Nm	3,3 kW	48 V - 83 A	10,5 Nm		
88-81	1,1 kW	12 V - 110 A	1100 rpm	9,6 Nm	--	--	--	--	--	--	--	--
	2,2 kW	24 V - 110 A	1500 rpm	14 Nm	2,2 kW	24 V - 110 A	2200 rpm	9,6 Nm	--	--	--	--
		36 V - 74 A			3,3 kW	36 V - 110 A		3400 rpm	9,3 Nm			
		48 V - 55 A			3 kW	48 V - 75 A		3000 rpm	14 Nm	4,4 kW	48 V - 110 A	3000 rpm

Tolerance ±10% Max. 1,1 kW a / at 12 V Max. 2,2 kW a / at 24 V Max. 3,3 kW a / at 36 V Max. 4,4 kW a / at 48 V

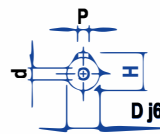
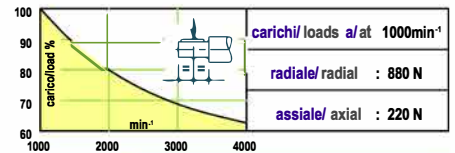
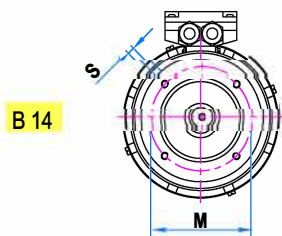
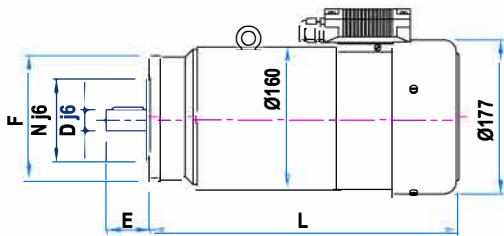

Shafts				
D	E	P	H	d
Ø19	40	6x6x30	21,5	M6
Ø24	50	8x7x35	27	M8

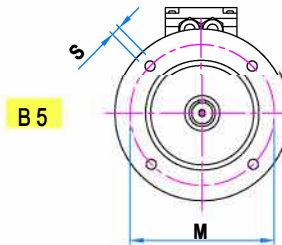
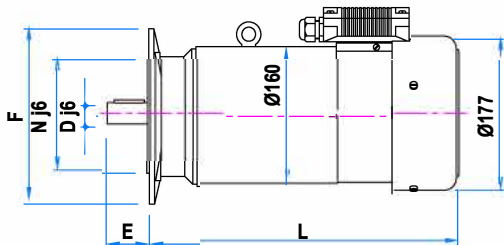

Flanges B5				
F	N	M	T	S
Ø200	Ø130	Ø165	3	Ø11

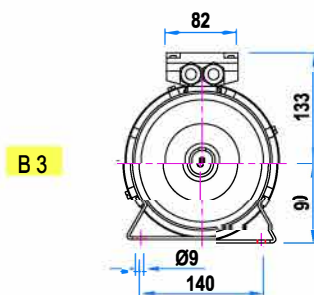
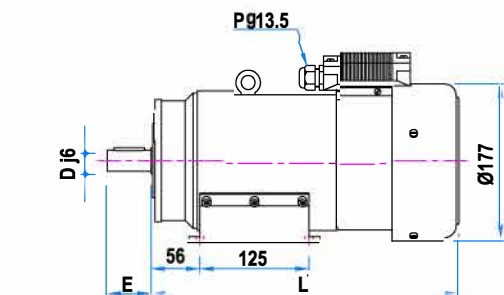

Flanges B14				
F	N	M	T	S
Ø140	Ø95	Ø115	3	M8

Type	L	Weight
88 - 38	354	22 Kg
88 - 57	409	29,6 Kg
88 - 81	464	37,2 Kg